

Delegated Decision

10 July 2019

Temporary Traffic Regulation Order

Ordinary Decision/Key Decision No.



Report of REGENERATION AND LOCAL SERVICES

Brian Buckley – Strategic Highways Manager, Technical Services

Electoral division(s) affected:

Murton: Cllr A Napier, Cllr J Maitland

Purpose of the Report

To consider a request for temporary traffic regulation by Order on 05/08/19 for the purpose of permitting new sewer installation works whilst maintaining safe access to Overdene.

Recommendation

It is recommended that the Council exercises its powers under the Road Traffic Regulation Act 1984 to effect a Temporary Traffic Regulation Order to facilitate the proposed works

Background

Works are proposed by Lumsden & Carroll to undertake sewer works within the confines of the highway in association with a Bellway Homes development.

Options

Other traffic management arrangements have been considered and the most appropriate method is to prohibit a right turn from B1285 into Overdene.

Recommendation

The recommendation is approved and that following, consultations with the Chief of Police, arrangements be made to progress the advertising of Public Notices and sealing of an Order.

Contact: Steven Galloway

Tel: 03000 267095

Appendix 1: Implications

Legal Implications

TTRO checked, prepared and advertised via Legal Services

Finance

Costs to be charged to the scheme/applicant.

Consultation

Chief of Police, Local Members, Public Transport Providers (via the Public Transport Team)

Equality and Diversity / Public Sector Equality Duty

N/A

Human Rights

No impact

Crime and Disorder

N/A

Staffing

Network Management Team

Accommodation

N/A

Risk

N/A

Procurement

Advertising in a public newspaper with costs recharged to the scheme/applicant

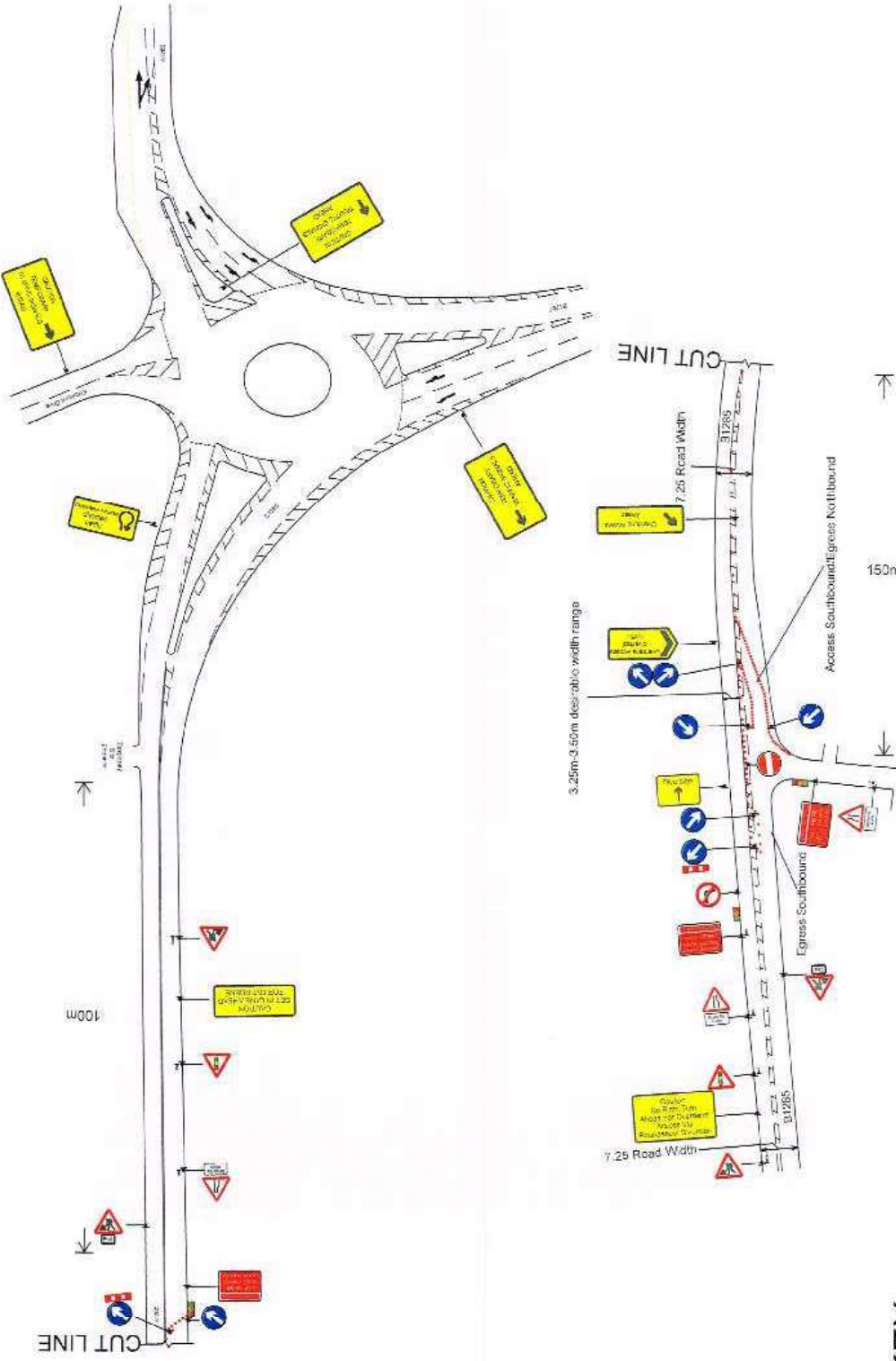
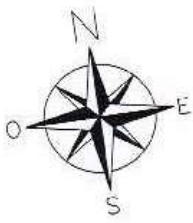

NOTE: Prior to setting out the traffic management Esh Construction will cut back the vegetation to allow to signs to be erected in the verge and avoid the footpath being blocked for pedestrians. A traffic management operative will remain on site to act as a traffic marshal to aid with the access/egress to and from Overdene due to the limited road width in Overdene the new drainage has to be open cut and to allow local resident access/egress to and from their properties road plate will be used to allow residents to pass over the trench when require. The vehicles will be asked to wait while the road plates are positioned then removed to allow work to continue. The traffic management operative will operate the system in manual mode to allow this to happen avoiding delay on the B1285.

- Traffic sign
- Traffic cone
- Traffic signal heads
- Working Space
- Pedestrian Barrier

KEY

	Sign 1 - No Entry
	Sign 2 - No Right Turn
	Sign 3 - No Left Turn
	Sign 4 - No U-Turn
	Sign 5 - No Through Road
	Sign 6 - No Entry
	Sign 7 - No Entry
	Sign 8 - No Entry
	Sign 9 - No Entry
	Sign 10 - No Entry
	Sign 11 - No Entry
	Sign 12 - No Entry
	Sign 13 - No Entry
	Sign 14 - No Entry
	Sign 15 - No Entry
	Sign 16 - No Entry
	Sign 17 - No Entry
	Sign 18 - No Entry
	Sign 19 - No Entry
	Sign 20 - No Entry
	Sign 21 - No Entry
	Sign 22 - No Entry
	Sign 23 - No Entry
	Sign 24 - No Entry
	Sign 25 - No Entry
	Sign 26 - No Entry
	Sign 27 - No Entry
	Sign 28 - No Entry
	Sign 29 - No Entry
	Sign 30 - No Entry
	Sign 31 - No Entry
	Sign 32 - No Entry
	Sign 33 - No Entry
	Sign 34 - No Entry
	Sign 35 - No Entry
	Sign 36 - No Entry
	Sign 37 - No Entry
	Sign 38 - No Entry
	Sign 39 - No Entry
	Sign 40 - No Entry
	Sign 41 - No Entry
	Sign 42 - No Entry
	Sign 43 - No Entry
	Sign 44 - No Entry
	Sign 45 - No Entry
	Sign 46 - No Entry
	Sign 47 - No Entry
	Sign 48 - No Entry
	Sign 49 - No Entry
	Sign 50 - No Entry
	Sign 51 - No Entry
	Sign 52 - No Entry
	Sign 53 - No Entry
	Sign 54 - No Entry
	Sign 55 - No Entry
	Sign 56 - No Entry
	Sign 57 - No Entry
	Sign 58 - No Entry
	Sign 59 - No Entry
	Sign 60 - No Entry
	Sign 61 - No Entry
	Sign 62 - No Entry
	Sign 63 - No Entry
	Sign 64 - No Entry
	Sign 65 - No Entry
	Sign 66 - No Entry
	Sign 67 - No Entry
	Sign 68 - No Entry
	Sign 69 - No Entry
	Sign 70 - No Entry
	Sign 71 - No Entry
	Sign 72 - No Entry
	Sign 73 - No Entry
	Sign 74 - No Entry
	Sign 75 - No Entry
	Sign 76 - No Entry
	Sign 77 - No Entry
	Sign 78 - No Entry
	Sign 79 - No Entry
	Sign 80 - No Entry
	Sign 81 - No Entry
	Sign 82 - No Entry
	Sign 83 - No Entry
	Sign 84 - No Entry
	Sign 85 - No Entry
	Sign 86 - No Entry
	Sign 87 - No Entry
	Sign 88 - No Entry
	Sign 89 - No Entry
	Sign 90 - No Entry
	Sign 91 - No Entry
	Sign 92 - No Entry
	Sign 93 - No Entry
	Sign 94 - No Entry
	Sign 95 - No Entry
	Sign 96 - No Entry
	Sign 97 - No Entry
	Sign 98 - No Entry
	Sign 99 - No Entry
	Sign 100 - No Entry

Reproduction & Copyright Notice
 This document is the intellectual property of Total Resources (UK) Plc. All rights of reproduction are strictly reserved without prior permission of the author. Forwarding to third parties or use of this material in any form without the prior written consent of the author is prohibited. Any or all material reproduction or use may lead to prosecution on civil or criminal grounds. Total Resources (UK) Plc reserves the right to use any or all material contained herein without notice.

Peterbello Industrial Estate
 Peterbello Way
 Bury, DA13 2SA
 0181 4823296
 07540 792786
 raycema@totalresources.co.uk



Esh Construction
 3 Phase Temporary Traffic Signals 40MPH
 B1285 junction with Overdene Seaham

Drawn by: Ray Demarco
 Checked by: Paul Thompson
 Original Drawing Size: A3
 SCALE: Not to scale
 DIMENSIONS: metres

Date: 09/07/2019
 Drg No: TMLS09071esh